

## LEGAL DESCRIPTION

All that certain real property situate in the City of Sparks, County of Washoe, State of Nevada, described as follows:

Starting at a given point marked by an iron stake about twenty feet East of the Southwest corner of section thirty-three, Township twenty east, Range twenty North; thence North one hundred-eighty feet to the ditch; thence following the ditch two hundred-sixty feet, southeasterly to the south line of section thirty-three; thence one hundred-ninety feet West along the South line of section thirty-three to the point of beginning, all in Washoe County, Nevada.

The above legal was taken from prior Document No. 837427.

James D. Bailey, Jr.  
P.L.S. 18368

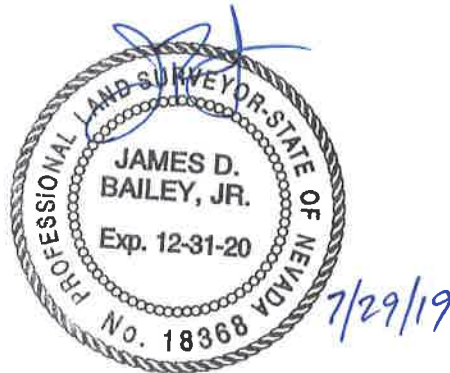

PREPARED BY THE FIRM OF  
**MERIDIAN SURVEYING & MAPPING, INC.**  
8725 TECHNOLOGY WAY, STE. C2  
RENO, NV. 89521

SURF THRU INC.  
028-310-05  
PARCEL 1, PM 5312

2050 PYRAMID WAY LLC  
028-310-06  
PARCEL 2, PM 5312

1620 PYRAMID WAY  
MARDIAN, ET AL  
APN: 028-310-01

HOLMAN  
WAY

PYRAMID  
WAY

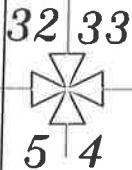

U.S.A.  
028-361-03

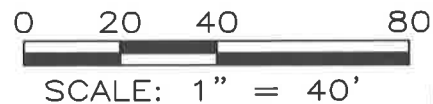
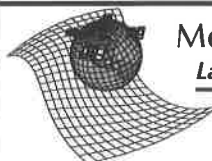

EXHIBIT MAP  
1620 PYRAMID WAY  
SPARKS, NEVADA  
APN: 028-310-01

DRAWN BY: TDM

CHECKED BY: JDB

DATE: JULY 2019



Meridian Surveying & Mapping, Inc.  
Land, Construction and Boundary Surveys

8725 Technology Way, Reno, NV 89521  
(775) 690-4194